

*solutions*  
**CPIDAYLIGHTING**

## GARDEN OF THE GODS

With a rich history steeped in centuries of ownership by the native Suquamish Tribe, the Kiana "Garden of the Gods" Lodge, located on Agate Passage on the North Kitsap Peninsula of Washington State, is a favorite for local weddings, banquets and corporate functions.

For years, however, extreme sunlight and glare would soak the hotel's Garden Atrium unfiltered, making it uncomfortable for those in the space.

"With the standard skylight panels we had before, we couldn't control the light and had too much sun and no insulation," said Jay Mills, Director, Kiana Lodge. "I'd gone up there and put black tablecloths and then had to lay bricks so that the wind wouldn't blow them away, all to accommodate the client."

Kiana Lodge contracted PHC Construction, and decided to retrofit the Garden Atrium with CPI Daylighting's IntelaSun® controlled daylighting system. The failing old skylight panels were replaced with 42 IntelaSun SolaQuad Unit Skylights, each 6' wide by 13' long. The new IntelaSun® system provides shading and automated control of daylight transmission, glare, and solar heat gain.

The SolaQuad® skylights at the Kiana Lodge also have zone controls that allow maximum control of daylight transmission. Mills' facilities team can pre-set each zoned group of skylights for automatic sun-tracking operation based on the unique conditions in that zone. Operable SolaBlades® are built in to the SolaQuad® skylights, and sensors gauge the sun's position, then dynamically manage the desired sunlight transmission, shading and solar heat gain inside the space. As Mills says, "You set it and forget it."

With enhanced solar heat, shade and glare control, Mills has finally been able to support more corporate events, a long-term goal for the Kiana Lodge. "We're trying to encourage more corporate functions which require more PowerPoint presentations and things of that nature," said Mills. "Now, [with the IntelaSun® controlled daylighting system], I can just hit a button and dim them. It's put the power back in the point."

The insulated SolaQuad® panels have enhanced energy efficiency at the Kiana Lodge and also eliminated problems with leakage from heavy Northwest rains. "We've noticed that we've been able to retain heat better, especially this winter. We were able to keep the building warmer," said Mills. "Another benefit to the skylights: We've had no more leaking - we don't have to give away as many umbrellas!"



**KIANA LODGE**  
POULSBORO, WASHINGTON

ARCHITECT  
NBSE ASSOCIATES

OWNER  
PORT MADISON ENTERPRISES

MANUFACTURER  
CPI DAYLIGHTING, INC.

GENERAL CONTRACTORS  
PHC CONSTRUCTION



*Before: Deteriorated leaking skylights caused extreme glare and heat build-up.*



*After: IntelaSun® provides control of light transmission, glare, and solar heat gain.*

28662 N. BALLARD DRIVE LAKE FOREST, IL 60045  
PHONE: (800) 759-6985 | FAX: (847) 816-0425  
WWW.CPIDAYLIGHTING.COM

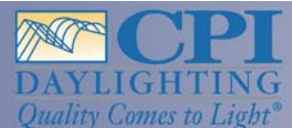

# KIANA LODGE



## SOLAQUAD® SINGLE SLOPES

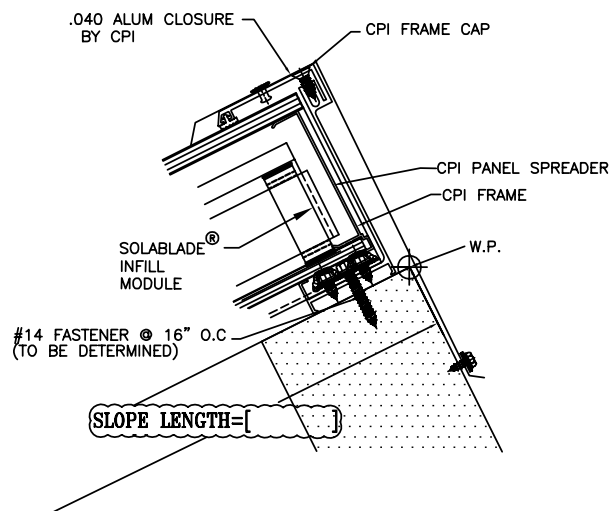

**C** SECTION @ HEAD FRAME  
SCALE 1/4"=1"

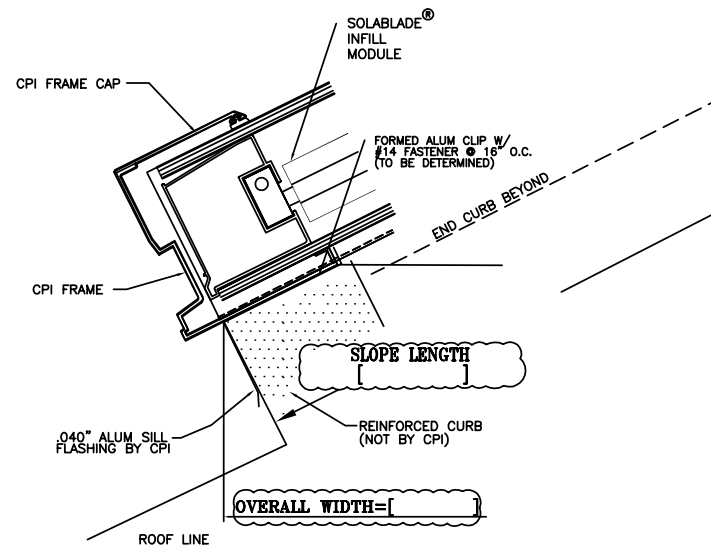

**G** SECTION @ SILL FRAME  
SCALE 1/4"=1"

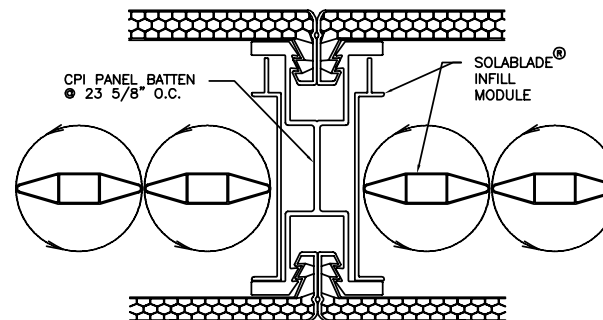
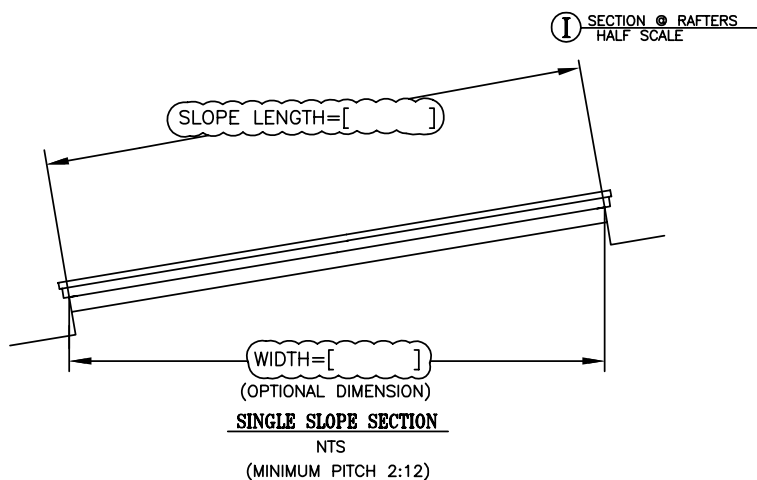

The information contained on this drawing is the property of CPI DAYLIGHTING, INC. This drawing can not be copied or used in any way without express written authorization of CPI DAYLIGHTING, INC.